

Figure 1

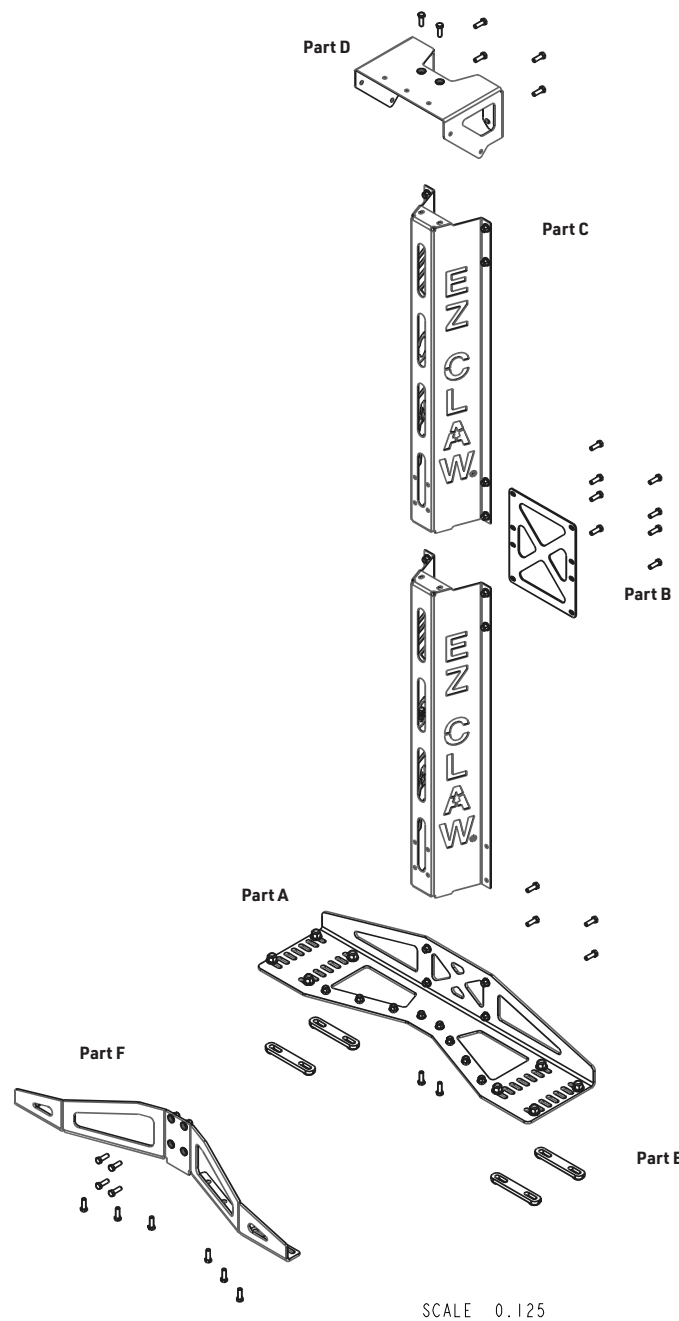

Figure 2

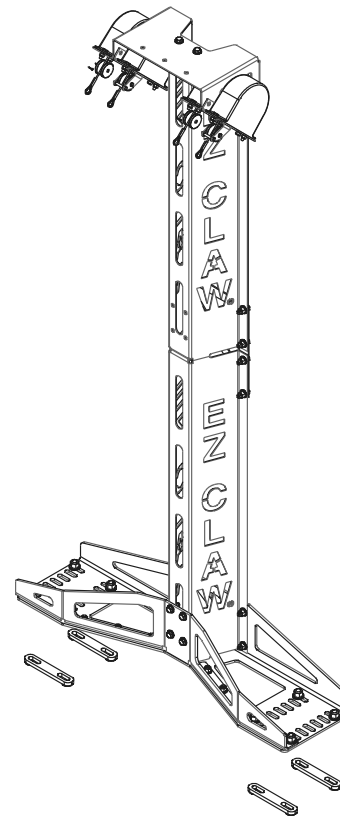
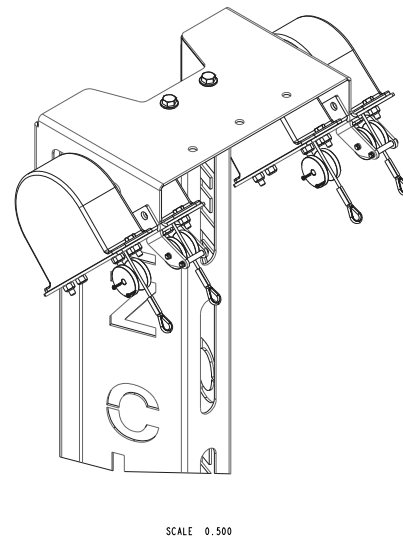

Figure 3



# EZ Claw Center Post Mount

## Installation Instructions

Item # EZCCPM | The **EZ Claw Center Post Mount** is a six-foot, stand-alone, bolt-on bracket that accepts tensioners and accessories when the back of the semi cab is inaccessible or the tractor's wheelbase is too long.

**Kit Includes:**

- (1) Base Plate Member (Part A)
- (1) Upright Support (Part B)
- (2) Center Post (Part C)
- (1) Universal Head Mount (Part D)
- (4) Frame Anchor (Part E)
- (1) Base Support Member (Part F)
- (8) 1/2-13 x 13" Long G8 Flange Bolt
- (8) 1/2-13 G8 Flange Lock Nut-YZN
- (36) 3/8-16x1" Long G8 Flange Bolt
- (36) 3/8-16 Flange Locknut

**Recommended Tools for Installation:**

- (1) Battery Powered Impact Driver
- (1) 3/4" Socket
- (1) 3/4" Open Ended Wrench
- (1) 9/16" Socket
- (1) 9/16" Open Ended Wrench



# EZ Claw Center Post Mount Parts List



**Part A**  
Base Plate Member  
# EZ-0241  
Qty: 1



**Part B**  
Upright Support  
# EZ-0242  
Qty: 1



**Part C**  
Center Post  
# EZ-0243  
Qty: 2



**Part D**  
Universal Head Mount  
# EZ-0244  
Qty: 1



**Part E**  
Frame Anchor  
# EZ-0245  
Qty: 4



**Part F**  
Base Support Member  
# EZ-0248  
Qty: 1



**Mounting Hardware**  
1/2-13 x 13" LONG G8 BOLT  
Qty: 8  
1/2-13 G8 FLAT WASHER-YZN  
Qty: 16  
1/2-13 G8 LOCK NUT-YZN  
Qty: 8



**Assembly Hardware**  
3/8-16x1" LONG G8 FL BOLT  
Qty: 36  
3/8-16 FL LOCKNUT  
Qty: 36

# Installation Instructions

## 1. Attach Part A to Part C.

Locate Base Plate Member (Part A) and Center Post (Part C). Set Part C on Part A and install nuts and bolts loosely through the four holes in the back and two holes in the bottom. Ensure head of the bolts are oriented as shown in Fig. 1 for proper frame rail clearance. After all nuts and bolts are installed, tighten all bolts.

## 2. Install nuts and bolts on Part F.

Locate Base Support Member (Part F). Install on assembly from Step 1. Loosely install four bolts and nuts through the front of Part F and six bolts from the bottom as shown. After all bolts are installed, proceed with tightening, making sure slotted holes for the frame are aligned.

## 3. Connect Part B to Part C.

Locate Upright Support (Part B) and connect to back side of Center Post (Part C) with four nuts and bolts. Do not tighten bolts at this time. Set assembly aside.

## 4. Attach Part D and Part C.

Locate the second Center Post Upright (Part C) and the Universal Head Mount (Part D). Set Part D on top of Part C and install nuts and bolts through the four holes in the back and two holes on top. After all bolts are installed, proceed with tightening.

## 5. Combine Head Assembly and Base Assembly.

Set Head Assembly (Step 4) on top of Base Assembly (Step 1-3). Loosely install four nuts and bolts through Part B and two nuts and bolts in the center to join in the uprights. After all nuts and bolts are installed, tighten all bolts.

## 6. Stand Center Post Mount up.

Stand assembled Center Post Mount in desired location on the frame rails of the truck. Watch for any obstructions that may be in the way.

## 7. Install Mounting Bolts.

Locate 1/2" Mounting Bolts from the included Mounting Hardware Kit. Install 13" bolts down through the base of the Center Post Mount avoiding any frame hardware that may exist on the truck.

## 8. Install Part E.

Locate Frame Anchor (Part E) and 1/2" flange nuts. Install Part E on two of the bolt assemblies making sure it crosses under the frame. Install 1/2" lock nuts. Repeat for the other three frame anchors.

## 9. Special Case.

If 1/2" Mounting Bolts are not used in the front hole of the Base Support Member (Part F), extra 3/8" bolts and nuts are included to secure these components.